

# \$2,199,999 - Twp 241 Range Road 261, Rural Wheatland County

---

MLS® #A2176879

**\$2,199,999**

0 Bedroom, 0.00 Bathroom,  
Land on 67.09 Acres

NONE, Rural Wheatland County, Alberta

Located 1.7Km South of Highway #1  
5 mins from the De Havilland Manufacturing  
Facility  
25Mins East of Calgary, 5 Mins West of  
Strathmore  
+/- 67 Acres of Industrial Zoned Land  
Fully Fenced yard  
Site Services to the property Line  
Phase 1 Ground Water Report Available

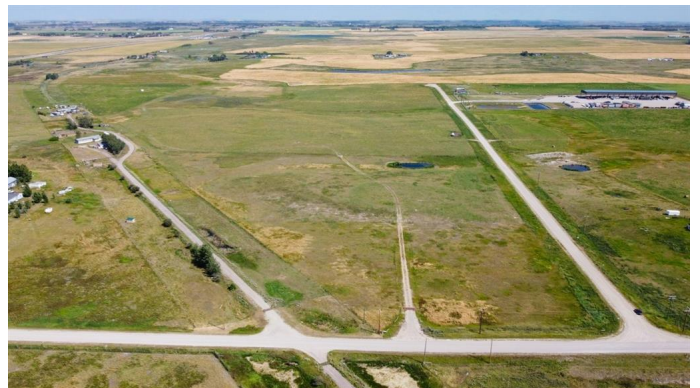

## Essential Information

MLS® #	A2176879
Price	\$2,199,999
Bathrooms	0.00
Acres	67.09
Type	Land
Sub-Type	Industrial Land
Status	Active

## Community Information

Address	Twp 241 Range Road 261
Subdivision	NONE
City	Rural Wheatland County
County	Wheatland County
Province	Alberta
Postal Code	T0J 1X0

## Exterior

Lot Description      Corner Lot, Wetlands

**Additional Information**

Date Listed            November 7th, 2024  
Days on Market      276  
Zoning                 IG

**Listing Details**

Listing Office         RE/MAX Key

Data is supplied by Pillar 9â„¢ MLS® System. Pillar 9â„¢ is the owner of the copyright in its MLS® System. Data is deemed reliable but is not guaranteed accurate by Pillar 9â„¢. The trademarks MLS®, Multiple Listing Service® and the associated logos are owned by The Canadian Real Estate Association (CREA) and identify the quality of services provided by real estate professionals who are members of CREA. Used under license.