

\$629,999 - 112 Legacy Reach Court Se, Calgary

MLS® #A2215256

\$629,999

3 Bedroom, 3.00 Bathroom, 1,747 sqft
Residential on 0.06 Acres

Legacy, Calgary, Alberta

OVER 1700 SQFT LIVING SPACE | LONG KITCHEN CENTRAL ISLAND | BONUS ROOM| SEPARATE ENTRANCE. This Beautiful Brand New Home built by Shane Homes Located on a Quiet Street in the Heart of Legacy with convenient access to restaurants, shopping, amenities, and schools. Upon Entry, the great room is designed with huge east-facing windows to have natural light sweeping throughout the day. The open-style living room invites you to the elegant kitchen filled with trendy selections, a pantry, Quartz countertops and stainless steel appliances and beautiful luxury vinyl plank throughout. Upstairs, youâ€™ll find two equally sized secondary bedrooms, bathroom and laundry space, along with a 3 - piece master suite including a walk-in closet. Thereâ€™s also a spacious bonus room at the centre of the house thatâ€™s roomy enough to host a large sectional sofa and entertainment unit, ideal for family movie nights. This exquisite home comes with a myriad of upgrades including 9 ft. ceiling heights on the main, Upgraded sleek cabinetry, LED pot lights, knock-down ceiling and modern lighting fixtures!

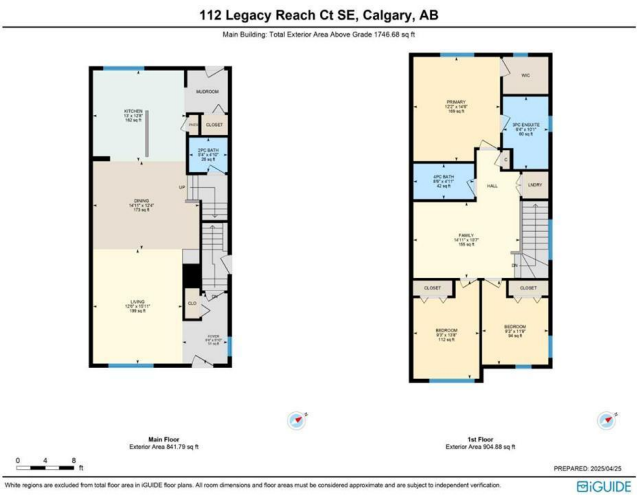
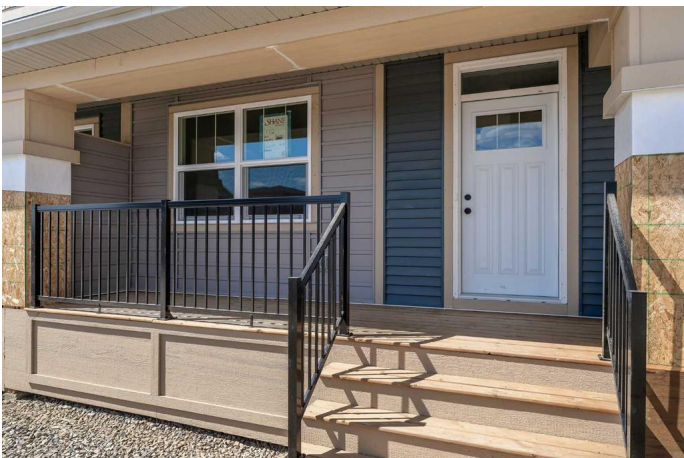

Built in 2025

Essential Information

MLS® # A2215256
Price \$629,999

Bedrooms	3
Bathrooms	3.00
Full Baths	2
Half Baths	1
Square Footage	1,747
Acres	0.06
Year Built	2025
Type	Residential
Sub-Type	Semi Detached
Style	2 Storey, Side by Side
Status	Active

Community Information

Address	112 Legacy Reach Court Se
Subdivision	Legacy
City	Calgary
County	Calgary
Province	Alberta
Postal Code	T2X5V2

Amenities

Parking Spaces	2
Parking	Parking Pad

Interior

Interior Features	High Ceilings, Kitchen Island, No Animal Home, No Smoking Home, Open Floorplan, Quartz Counters, Separate Entrance
Appliances	Dishwasher, Electric Range, Refrigerator
Heating	None
Cooling	None
Has Basement	Yes
Basement	Full, Exterior Entry, Unfinished

Exterior

Exterior Features	Playground
Lot Description	Back Lane
Roof	Asphalt Shingle
Construction	Vinyl Siding, Wood Frame
Foundation	Poured Concrete

Additional Information

Date Listed	April 26th, 2025
Days on Market	51
Zoning	R-1

Listing Details

Listing Office	Executive Real Estate Services
----------------	--------------------------------

Data is supplied by Pillar 9â„¸ MLS® System. Pillar 9â„¸ is the owner of the copyright in its MLS® System. Data is deemed reliable but is not guaranteed accurate by Pillar 9â„¸. The trademarks MLS®, Multiple Listing Service® and the associated logos are owned by The Canadian Real Estate Association (CREA) and identify the quality of services provided by real estate professionals who are members of CREA. Used under license.