

# \$8 - 4628 62 Street, Red Deer

MLS® #A2216425

**\$8**

0 Bedroom, 0.00 Bathroom,  
Commercial on 0.00 Acres

Riverside Light Industrial Park, Red Deer,  
Alberta

Located in Riverside Light Industrial Park, this space offers 11,206 SF with a reception area/lobby, six offices (some with windows), two meeting rooms/boardrooms, a file room, multiple storage rooms, and two washrooms. The large shop has 20' ceilings and is separated into two areas with (5) 14' overhead doors. The yard is fenced and graveled with paved parking available directly in front. Additional Rent is \$4.06 for the 2025 budget year.

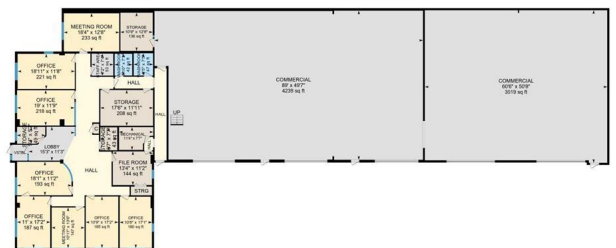

Built in 1992

## Essential Information

MLS® #	A2216425
Price	\$8
Bathrooms	0.00
Acres	0.00
Year Built	1992
Type	Commercial
Sub-Type	Industrial
Status	Active

## Community Information

Address	4628 62 Street
Subdivision	Riverside Light Industrial Park
City	Red Deer
County	Red Deer
Province	Alberta



Postal Code            T4N 6T3

### **Additional Information**

Date Listed            May 1st, 2025

Days on Market       104

Zoning                 I1

### **Listing Details**

Listing Office           RE/MAX Commercial Properties

Data is supplied by Pillar 9â„¢ MLS® System. Pillar 9â„¢ is the owner of the copyright in its MLS® System. Data is deemed reliable but is not guaranteed accurate by Pillar 9â„¢. The trademarks MLS®, Multiple Listing Service® and the associated logos are owned by The Canadian Real Estate Association (CREA) and identify the quality of services provided by real estate professionals who are members of CREA. Used under license.